

**MAJOR
INDUSTRIES**

MIXED GLAZED SYSTEMS

MULTIPLE GLAZING MATERIALS ADD FUNCTIONALITY AND DESIGN IMPACT

AluSpec
Fenestration
Design

your local sales rep
(608) 825-4838



CREATING ENVIRONMENTS WHERE PEOPLE CAN SHINE™



Main Cover Image © C. Rossini

MIXED GLAZED SYSTEMS

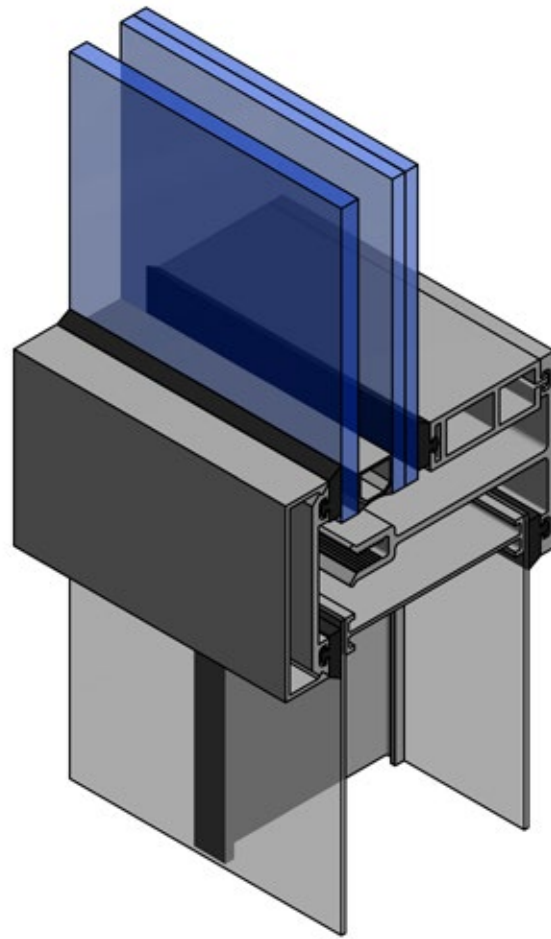

Wall Systems - Highlighting Views

Translucent wall systems provide numerous benefits, including diffusion of light and high thermal performance, as well as privacy and the blockage of a direct line of sight into interior spaces. But when design or need dictates glass glazing, consider incorporating sections of glass that allow for views and unique framing of exterior spaces.

- Our systems allow for a seamless look and easy integration - and are available in both 2.75" and 4" panel configurations.
- Small sections of glass can be used to highlight specific views.
- Polycarbonate multi-wall panels can be incorporated into the system to provide some visual dissonance or to inject color and pattern.

Contact us with your wall system needs and we'll help walk you through our solutions.



Mix-and match materials...
888-759-2678 / www.majorskylights.com

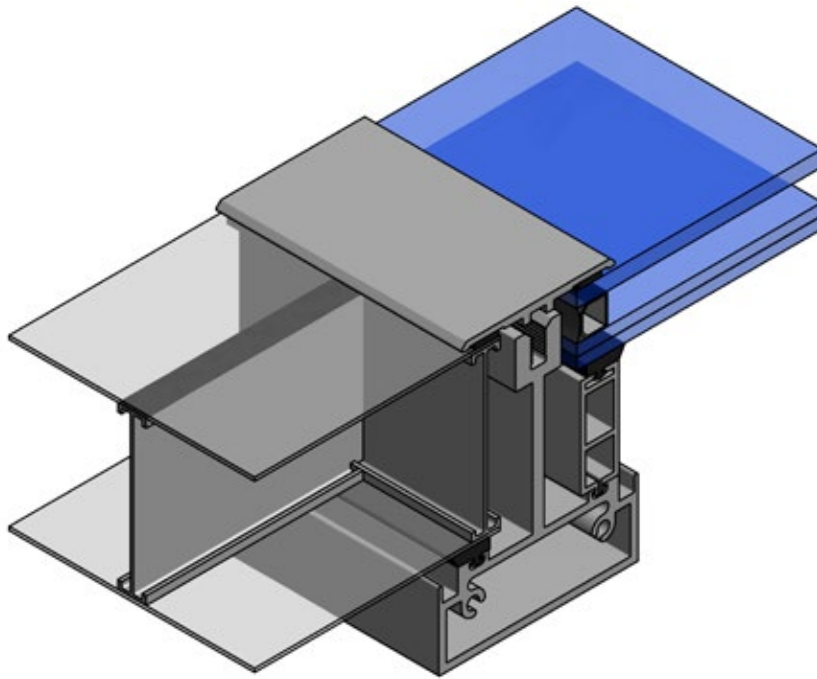

Skylights - Add Major Visual Appeal

Skylights can be utilitarian or incredibly dramatic. They can be the focal point or blend into their surroundings. No matter what their function, translucent panel skylights offer tremendous benefits to building occupants and the bottom line. By blocking direct rays of sunlight, hot-spots and glare are eliminated and diffuse natural light fills the space.

But when a space demands views to the sky, Major can provide a daylighting solution that's both unique and utilitarian. By combining the sun control properties of translucent panels with glass glazing's inspiring views, you can create a skylight that has optimal functionality and an eye-catching look. Examples of skylight glazing combinations include:

- Using glass along the center of a ridge for optimal lighting of an atrium or courtyard.
- Utilizing glass on the north-facing side of a ridge skylight, allowing for direct light to be diffused while allowing the maximum amount of indirect light into the space.
- Adding sections of polycarbonate multi-wall to add dramatic color to a skylight, including at the top of a pyramid or in alternating sections of a single slope.

No matter what your design demands, Major will work with you to make it a reality.



... as well as functionality and design impact!

888-759-2678 / www.majorskylights.com

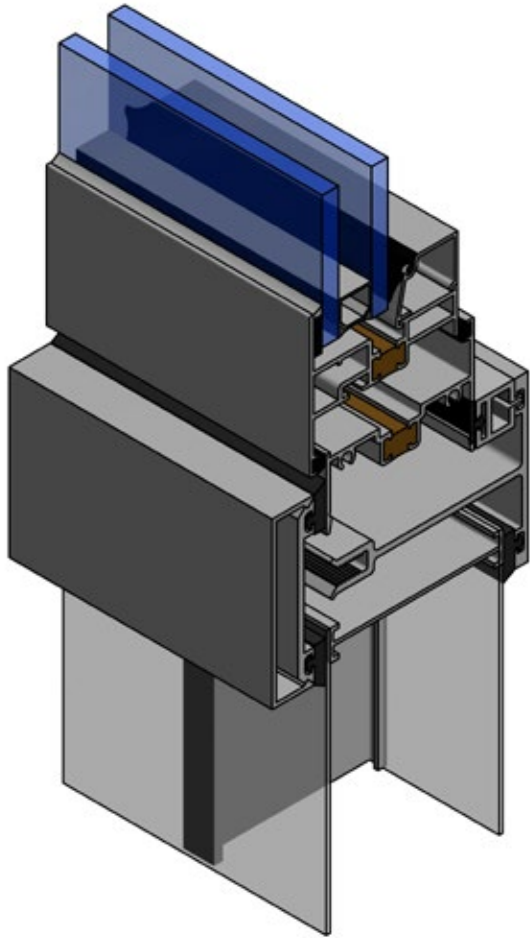

Operable Window Wall Systems

If a space demands occupant ventilation control, consider Major's operable window options. Operable windows are available for integration into both 2.75" and 4" panel systems, providing optimal performance as well as a clean, fully integrated look.

- High-performance hinges and locking hardware come standard for long-term durability.
- Numerous glazing options are available, including dual, triple and quad paned glass, low-E coatings, and more (contact us for available window offerings and options).

We also provide a pultruded fiberglass framed window for our Clima-Tite™ wall system, allowing for enhanced thermal performance over traditional aluminum. Call or email us for more information.

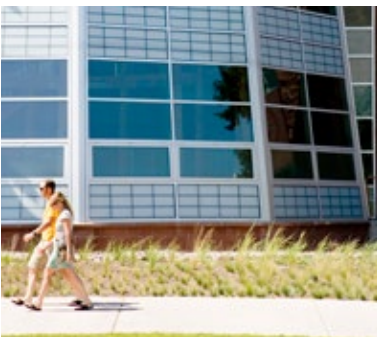

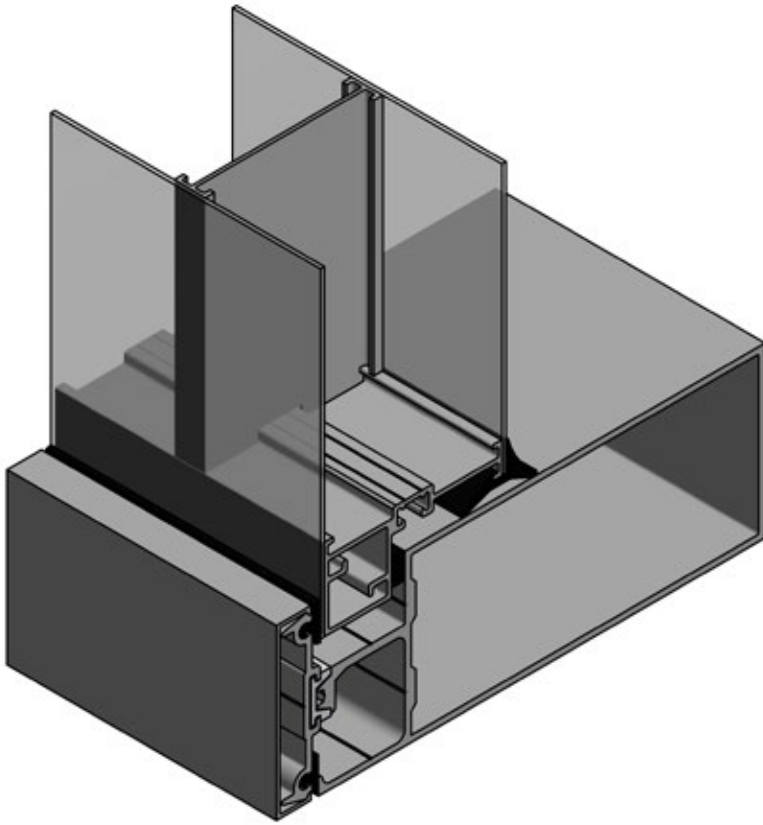

Translucent Adapter Panel & 1" Panels

Looking to retrofit existing curtainwall framing with translucent panels? Or maybe you're looking for an easy way to integrate built-in light control into a new system? Guardian 275[®] Translucent Adapter Panels might be the perfect solution!

- Specially designed to allow a 2.75" panel to fit industry standard 1" glazing pockets.
- Simple installation and a cohesive single system look.
- Enhanced thermal performance over traditional glass glazing.

If light diffusion is your main concern, we also manufacture 1" thick translucent panels that are lightweight and provide glare-free natural light. Not sure which system is right for your next project? Contact us today, and we'll work with you to find the right solution for your needs and budget.



... as well as functionality and design impact!

888-759-2678 / www.majorskylights.com



ABOUT MAJOR INDUSTRIES, INC.

Major Industries engineers and manufactures custom skylights and translucent wall systems that fit your needs - and your budget. With nearly forty years of experience, we know that architects, designers and owners are looking for tough, dependable and cost-effective daylighting systems, and we've created a wide range of systems to fit every need – all backed by industry-best warranties and an excellent on-time delivery record.

Your decision to use Major Industries is a sign of trust we take seriously. From finding the right system to structural engineering assistance, we will help you conquer your toughest design challenges. Whether your project demands light-controlling translucent panel systems that eliminate glare and block damaging UV, a glass skylight, or a unique mixed glazed system, we provide reliable daylighting solutions that let natural light in while keeping the elements out.

For more information, visit us online at www.majorskylights.com.



Major Industries provides nationwide training to Architects with its certified continuing education programs.

Major Industries, Inc. reserves the right to improve products without notice as the result of ongoing R&D and/or third-party compliance. Images are for illustration only and may represent related Major Industries systems. Cutaway and part illustrations are for reference only and may change with final design parameters. ©2019



SKYLIGHTS, CANOPIES & TRANSLUCENT WALL SYSTEMS

MAJORSKYLIGHTS.COM

7120 STEWART AVE, WAUSAU, WI. 54401

SALES@MAJORSKYLIGHTS.COM / 888-759-2678 / 715-842-4616

